

# project tanffordd underpass



## 1 in 5 women don't feel safe

Women don't feel safe going out after-dark in Cardiff according to a study by FOR Cardiff in 2023.



## Underpasses are crime hotspots

Underpasses are often crime hotspots, many people don't feel safe due to poor lighting, visibility and litter (BRE 2015).



## First impressions count

Many of the underpasses are routes into Cardiff, often being the first impression of the city for visitors and tourists.



## Project Overview

**Project Tanffordd** aims to enliven the underpasses of Cardiff. The general public, especially women, often don't feel safe walking through underpasses as they are poorly lit, hidden from view, and prone to crime. For example, the pedestrian underpass next to Cardiff Central Railway Station has reported 26 bike thefts and 16 violent/sexual offences.

We see an opportunity to transform these covered spaces into habitable areas, with natural surveillance, appropriate lighting, and playful wayfinding. We propose applying small interventions, i.e., a 'kit of parts,' to the many underpasses across the city, which form vital routes into the centre, used by both locals and visitors to Cardiff.

Our case-study underpass, near Cardiff Central Railway, is used by pedestrians and cyclists and forms part of the Taff Trail. Using reclaimed ductwork from building site waste, we have designed playful installations that encourage users of all ages to engage with the sounds of the city. A stage is proposed to host small musicians, dancers, and speakers, such as buskers, giving them a sheltered public space to share their talents. A kiosk will support the space by offering hot drinks and a place for musicians to sell their music. The massing of the solid components has been constrained by sight lines across the underpass, ensuring all areas remain visible. Finally, lighting and paintwork create an evenly lit, bright space that celebrates the unique architecture of each underpass while offering directions to pedestrians and cyclists passing through.

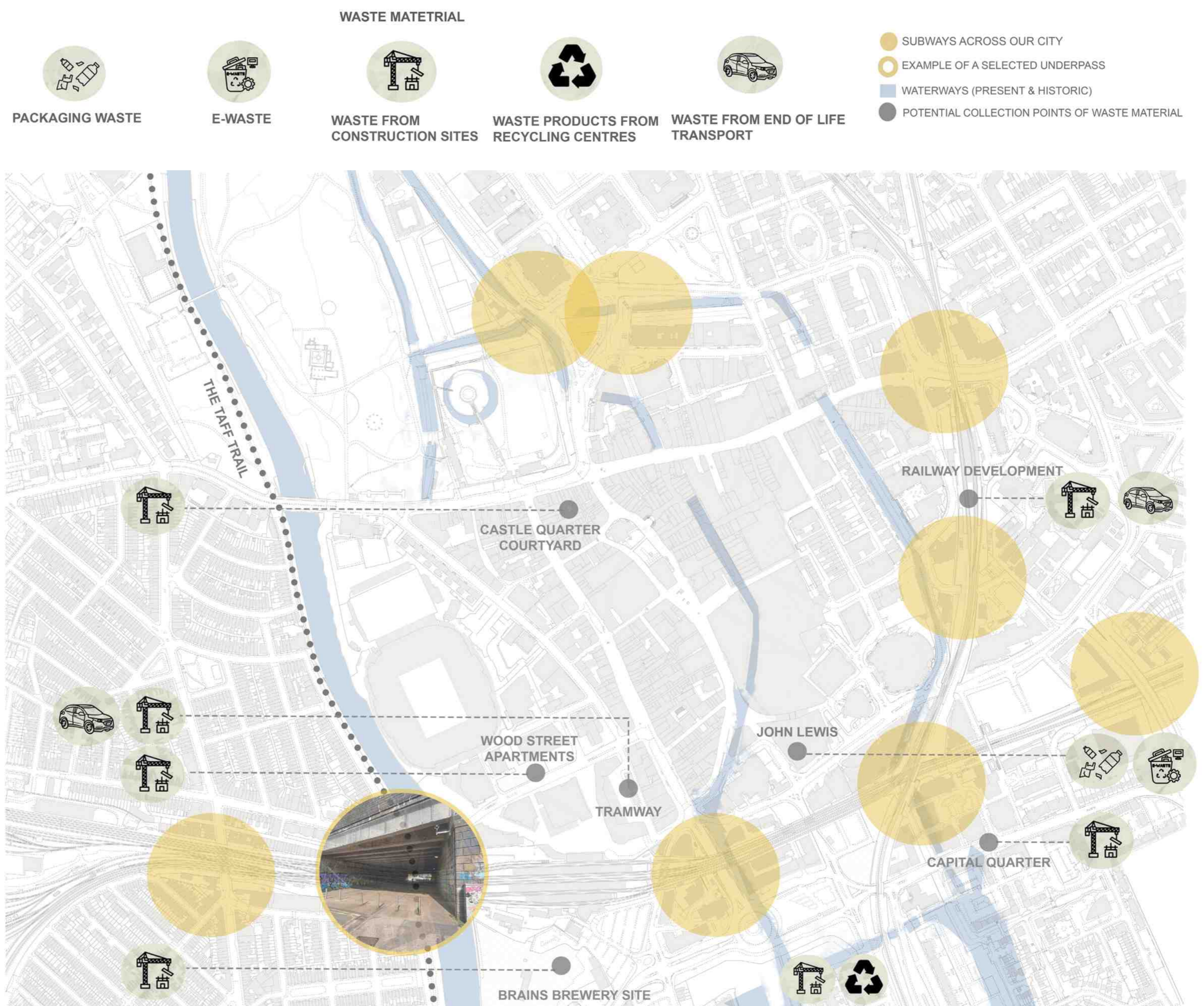
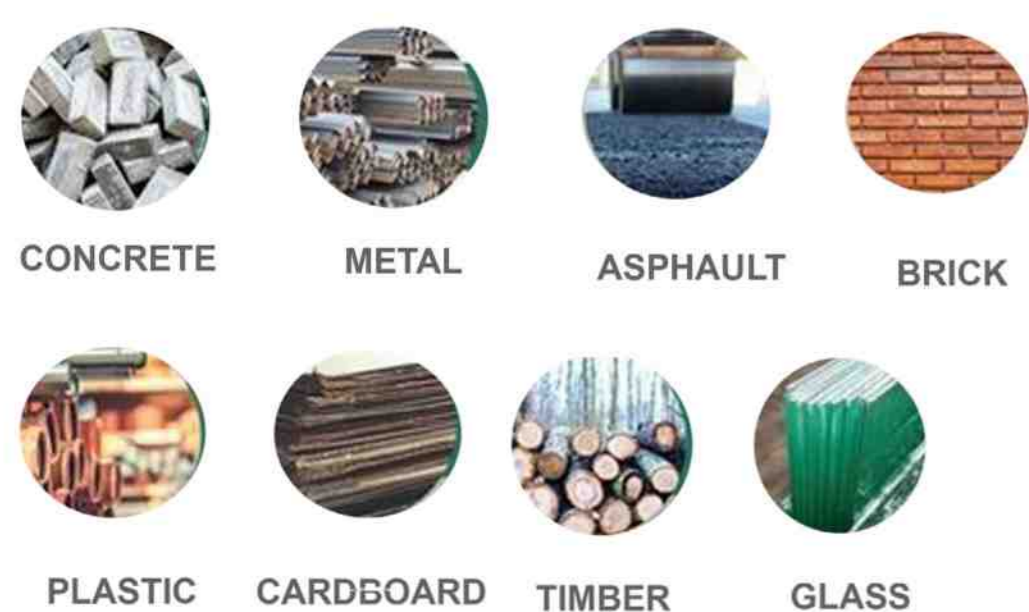



# project tanffordd underpass

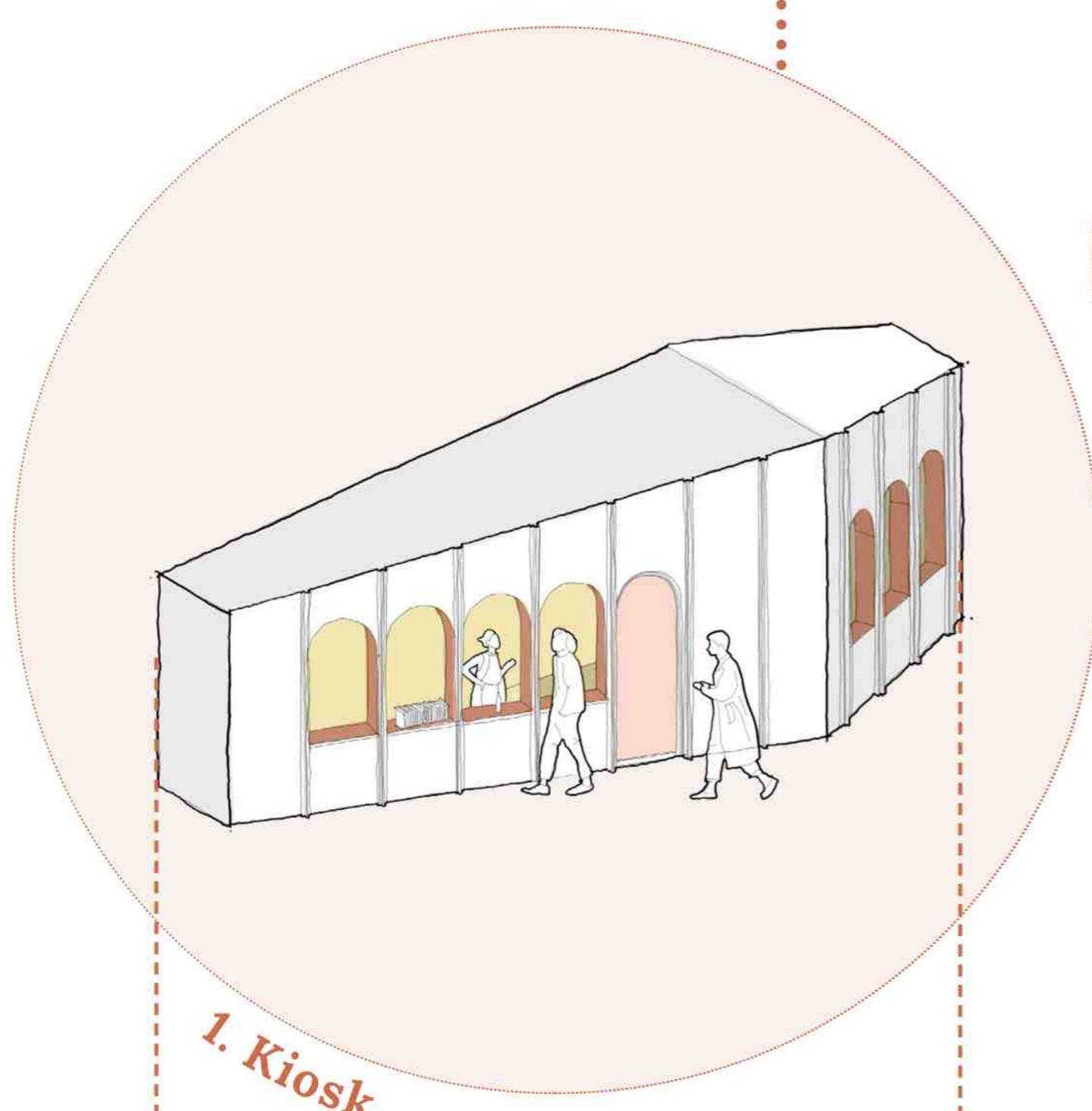
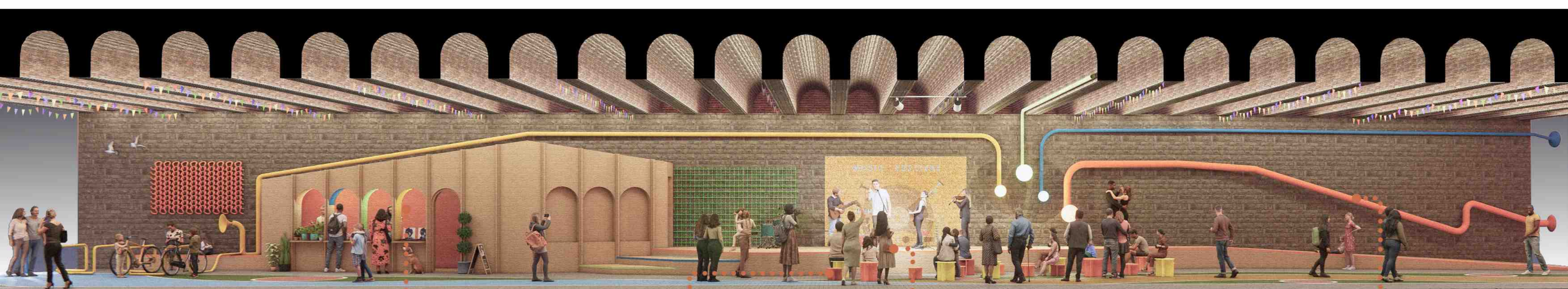
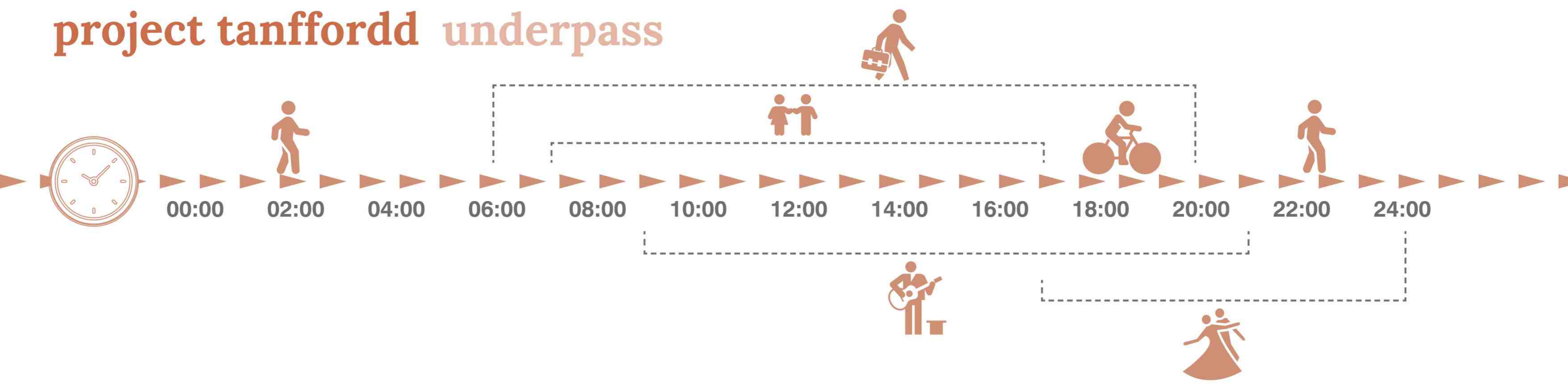

## 1. Kiosk

The kiosk will provide space for local small businesses and food vendors to sell their products. It will also serve as a means of natural surveillance, making the underpass feel lively and inhabited at all times of the day.

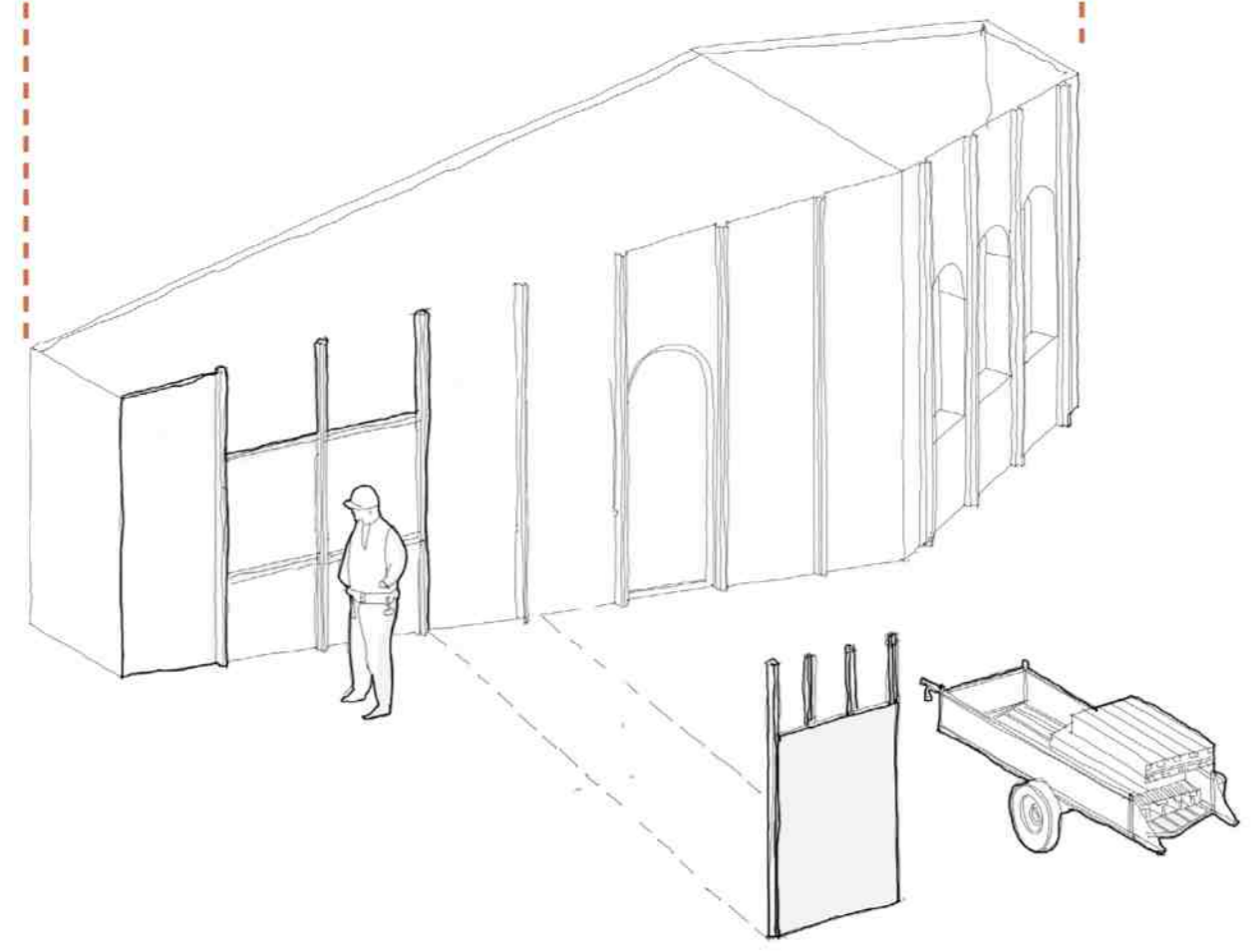

## Design for Disassembly

Using modular prefabricated panels for the kiosk and stage will allow them to be easily removed and relocated to other areas of the city. Additionally, the use of recycled materials will reduce production costs and make these spaces more sustainable to maintain in the long term.

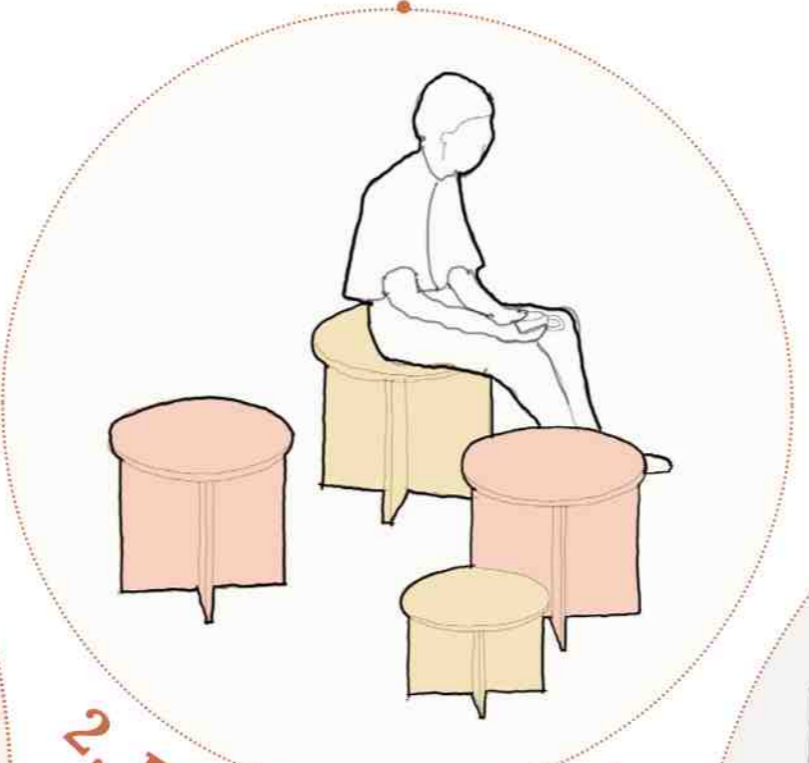

## 2. Pop-up seating

Modular, collapsible seating could be incorporated as a space for respite for older people and children, as well as providing seating for performances and cinema screenings.

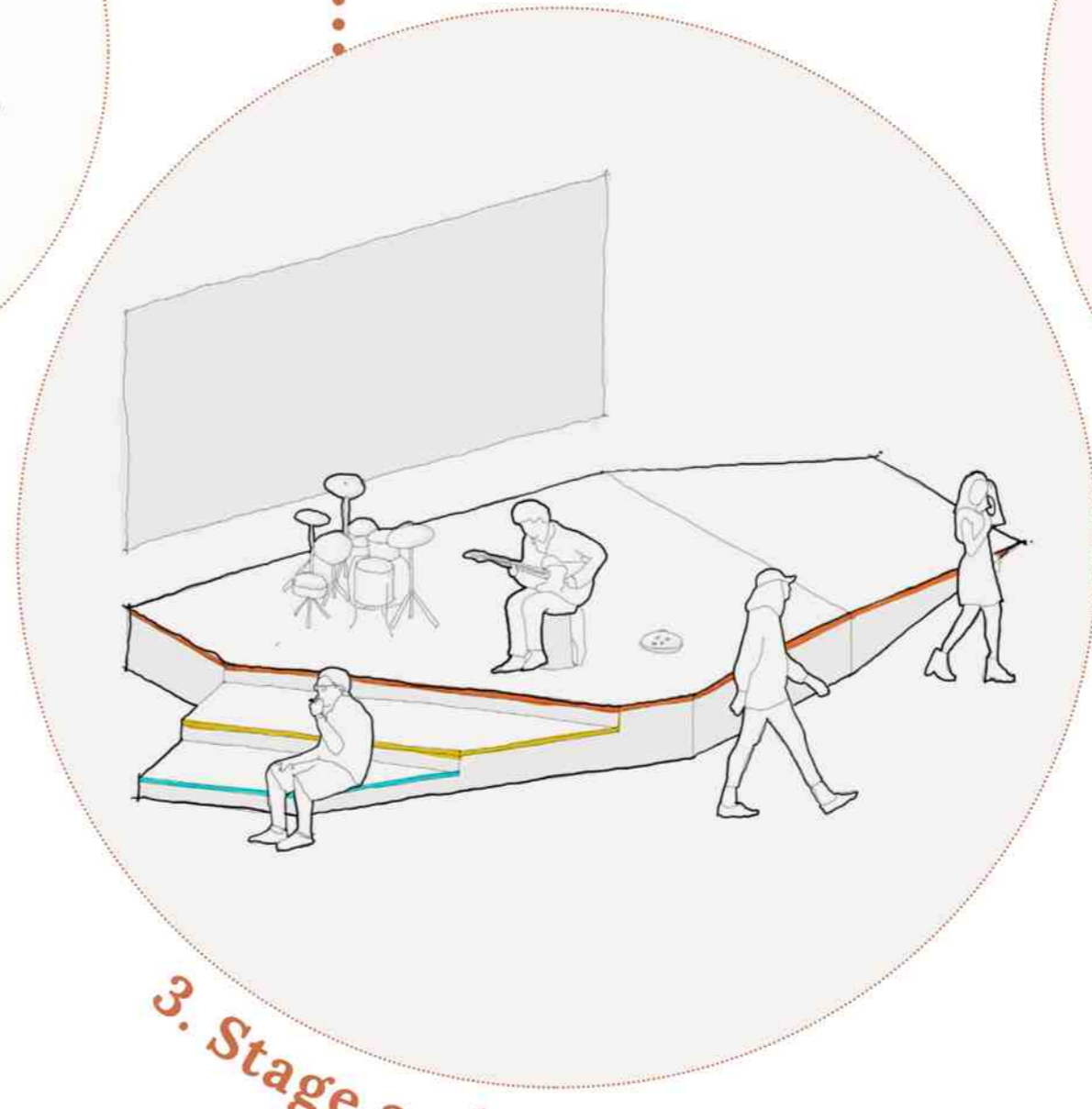

## 3. Stage and screen

The stage creates a space for performance artists during the day and cinema screenings in the evenings. Additionally, it could double as a play area for children.



## 4. Playful wayfinding

Recycled materials and ductwork can be used to create play areas for children and playful wayfinding throughout the underpass. Engaging local artists in the production process will also create job opportunities and support the wider community.

## Precedents

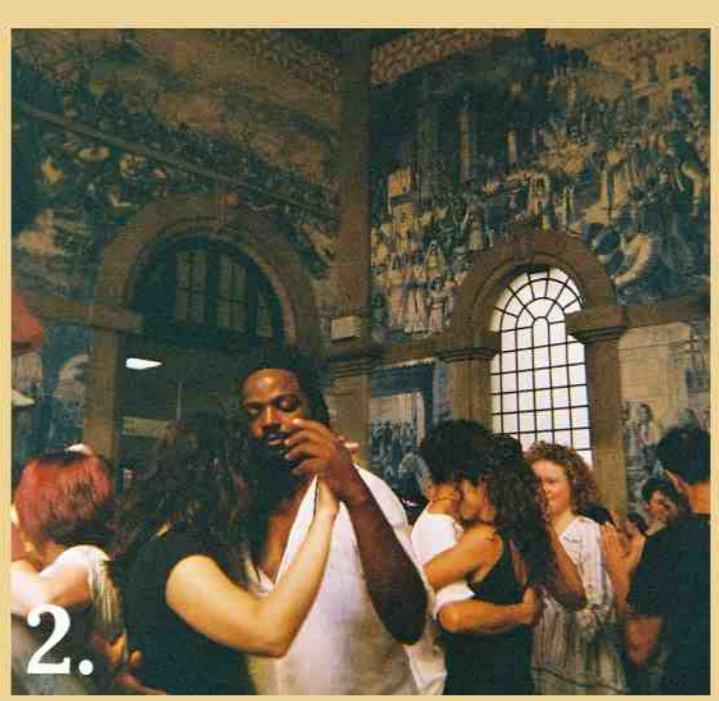
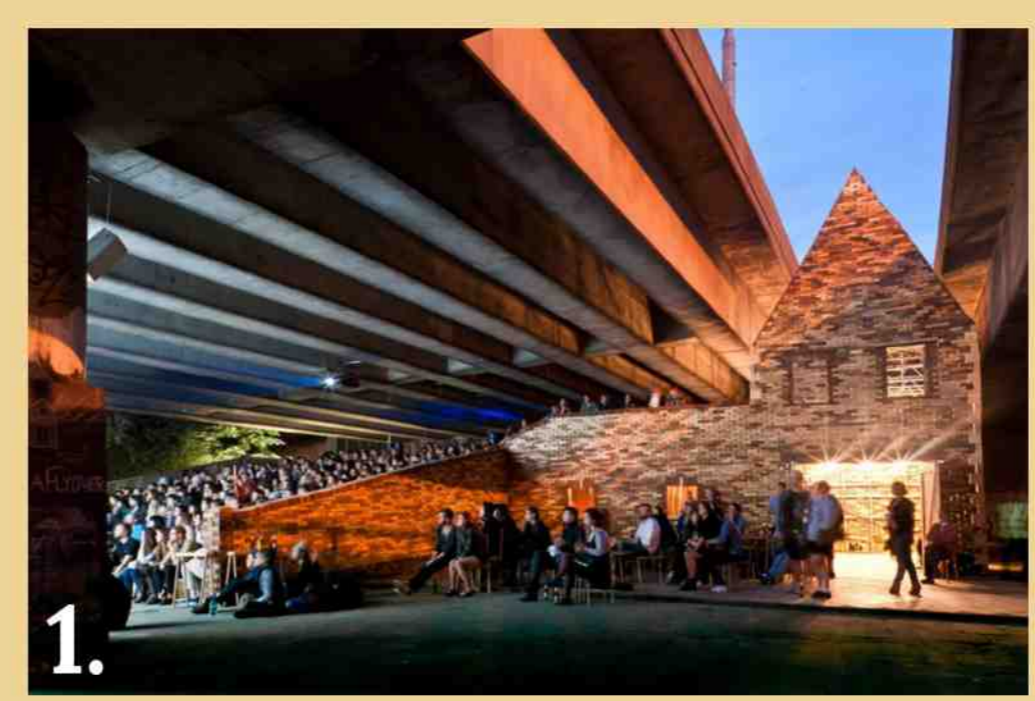

### 1. Folly for a Flyover

Transformed the undercroft of the A12 motorway, on the northern fringe of the 2012 Olympic Park, into an outdoor waterside cinema, café and performance space. Folly brought art and the community together to a forgotten, disused corner of the city, transforming it into a new social space.

### 2. Porto Train Station

Doubles up as dancing space in the evenings in the heart of the city.

### 3. Battersea Underpass

The underpass is located just before Battersea Power Station and offers space for art installations, a learning hub, and bike rentals.

### 4. Studio Tip

A creative studio exploring circular solutions for waste resources. The sculptures focus on how materials from construction can be reused in creative ways as part of a circular economy.